

YARVIK

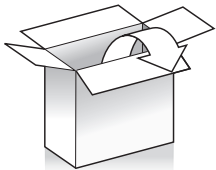

TAB310

8" tablet



1x



1x



1x

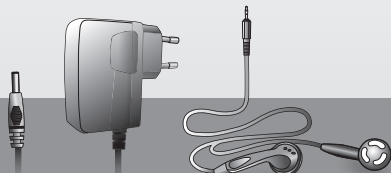

1x

1x



1x



1x

Please visit our website for CE declaration: www.yarvik.com



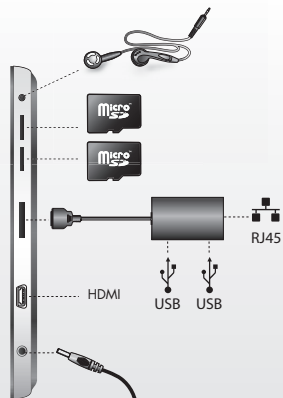
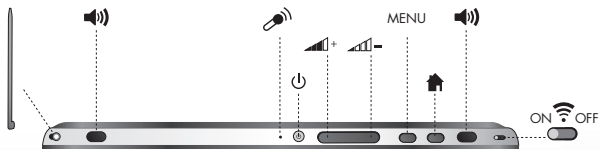

RESET

Wired connection



Internet / Router

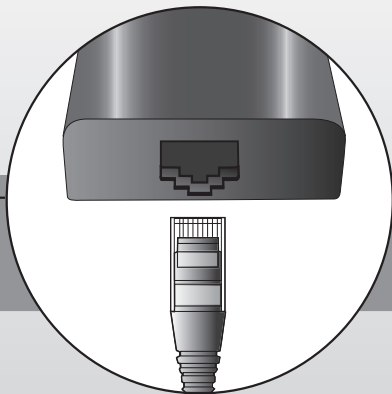
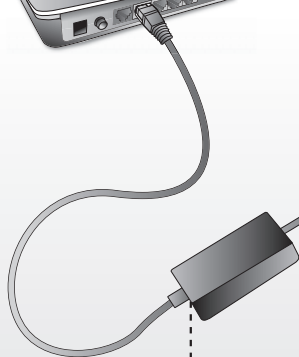

Connecting USB

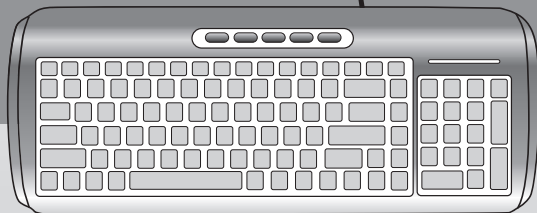
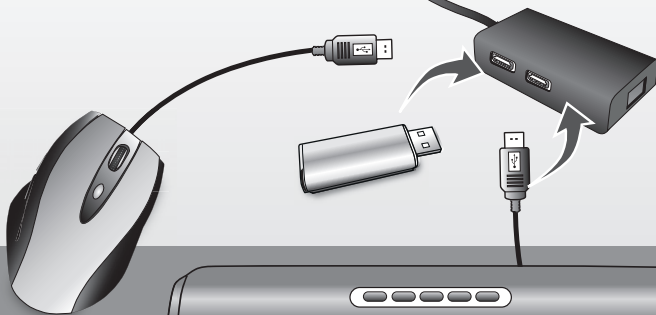

Factory Reset

Step 1

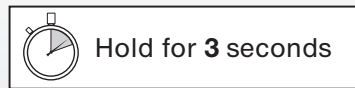
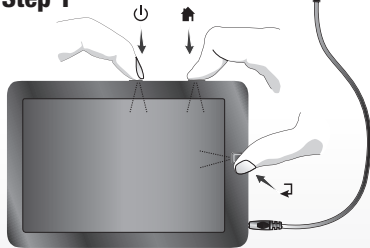

Step 2

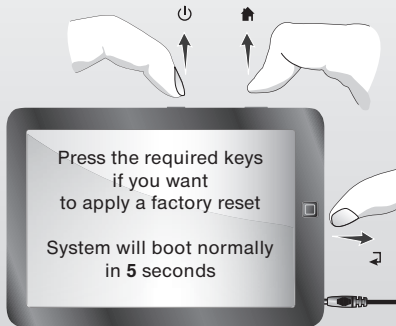

Step 3

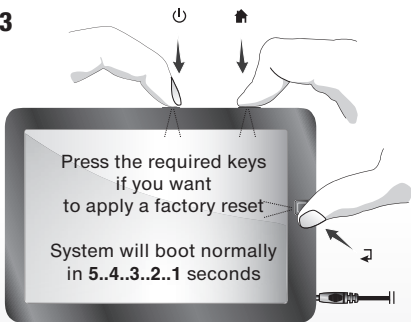

Step 4



Step 5

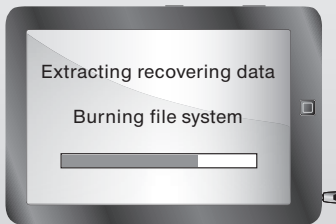

Factory Reset 6



System will start in 3 seconds





facebook.com/yarvik



twitter.com/yarvikce

YARVIK.COM